



LIFAN

Parts Catalog

LF150-10F

2018 Edition



UNIVERSAL

H A R D W A R E[®]

Box 585, Center Road
Spanish Lookout
Tel 501 823 0254
sales@universalhardware.bz

3380 Chetumal Street
Belize City
Tel 501 224 4140
salesbz@universalhardware.bz



ML100-A



LF110-7A



LF1200DT



ML125-5



ML125-7



ML125T-26



LF150-7



LF150GY-3B



LF200GY-4



LF250GY-4



LF150-10F



LF150-10S



ML200-16D



ML250-4



ML200ZH-3



1501061-1	Headlight Assy	
1501061-2	Circlip	
1501061-3	Socket set, front position light	
1501061-4	Bulb, HS112V35/35W	
1501061-5	Socket set, front position light, LH	
1501061-6	Case, meter	
1501061-7R	Ornament, headlight housing, RH Red	
1501061-8	Guard, RH	
1501061-9	Housing set, headlight	
1501061-10	Guard, LH	
1501061-11R	Ornament, headlight housing, LH Red	

F-02 仪表总成 METER

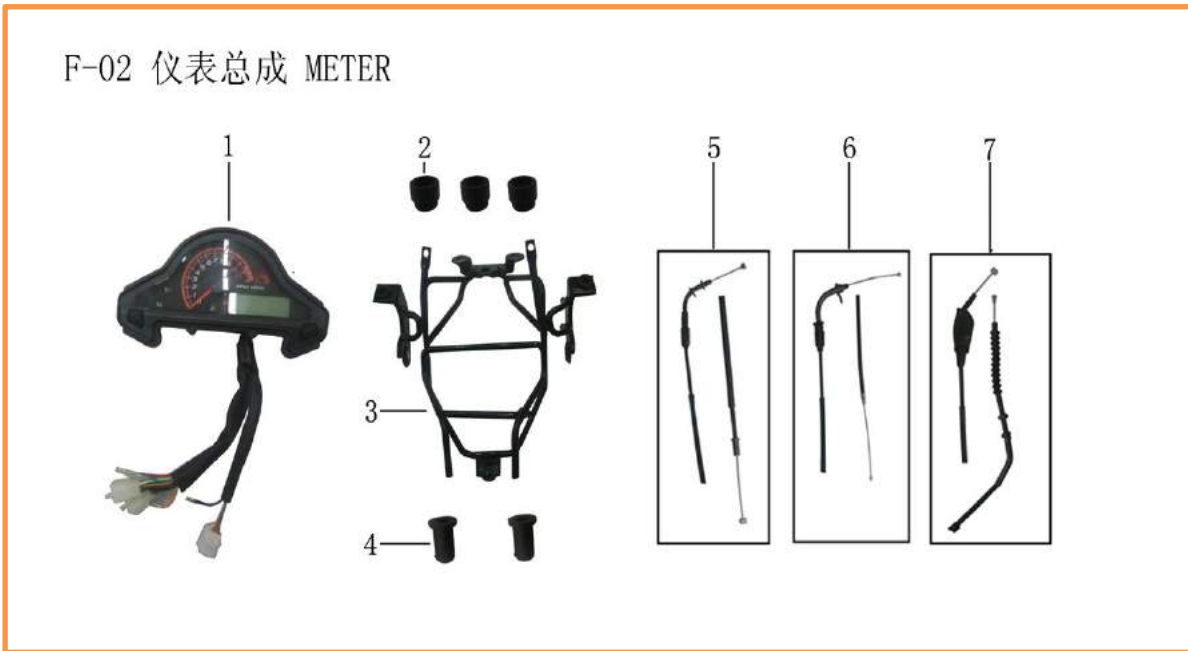

1501062-1	Meter Assy	
1501062-2	Meter Gasket	
1501062-3	Stay comp., headlight	
1501062-4	Boot, headlight stay	
1501062-5	Cable, choke	
1501062-6	Cable comp., throttle	
1501062-7	Cable, clutch	



1501063-1	Lever comp., clutch	
1501063-2	Lever, clutch	
1501063-3	Mirror, rearview, LH	
1501063-4	Mirror, rearview, RH	
1501063-5	Weight, steering bar	
1501063-6	Grip, LH	
1501063-7	Switch, handlebar, LH	
1501063-8	Switch, handlebar, RH	
1501063-9	Grip comp., throttle	

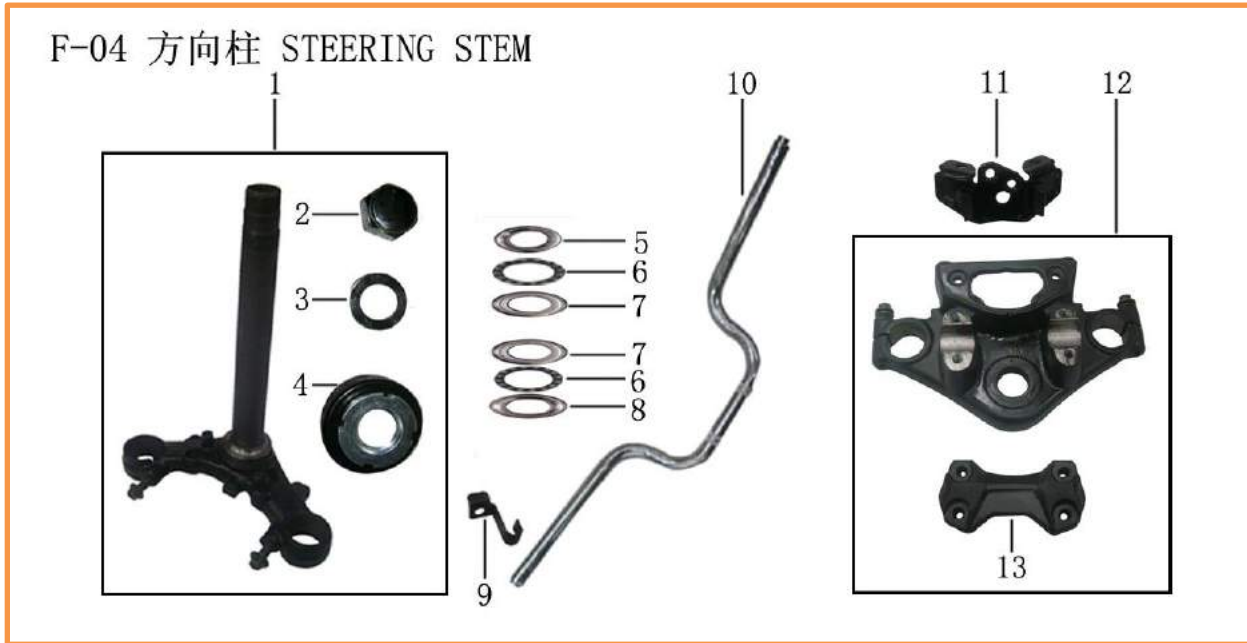

1501064-1	Stem set, steering	
1501064-2	Nut, cap, M24x1-17	
1501064-3	Washer, plain, 24.5xΦ37-1	
1501064-4	Dust cover, steering stem	
1501064-5	Top Bearing Top Ball Race	
1501064-6	Steering Stem Bearing Set	
1501064-7	Top Bearing Bottom Ball Race	
1501064-8	Bottom Bearing Bottom Ball Race	
1501064-9	Lug, speed sensor	
1501064-10	Pipe set, steering bar	
1501064-11	Lid comp., ignition switch lock	
1501064-12	Bridge, upper	
1501064-13	Clamp, steering bar	

F-05 前挡泥板 FRONT FENDER



1501065-1R	Front Fender Red
1501065-2	Lining set, front fender

F-06 前液压制动器总成 FRONT HYDRAULIC BRAKE ASSY



1501066-1	Front Hydraulic Brake Assy	
1501066-2	Front Brake Switch	
1501066-3	Front Brake Lever	
1501066-4	Front Brake Shoe Set	

F-07 減震器 SHOCK ABSORBER

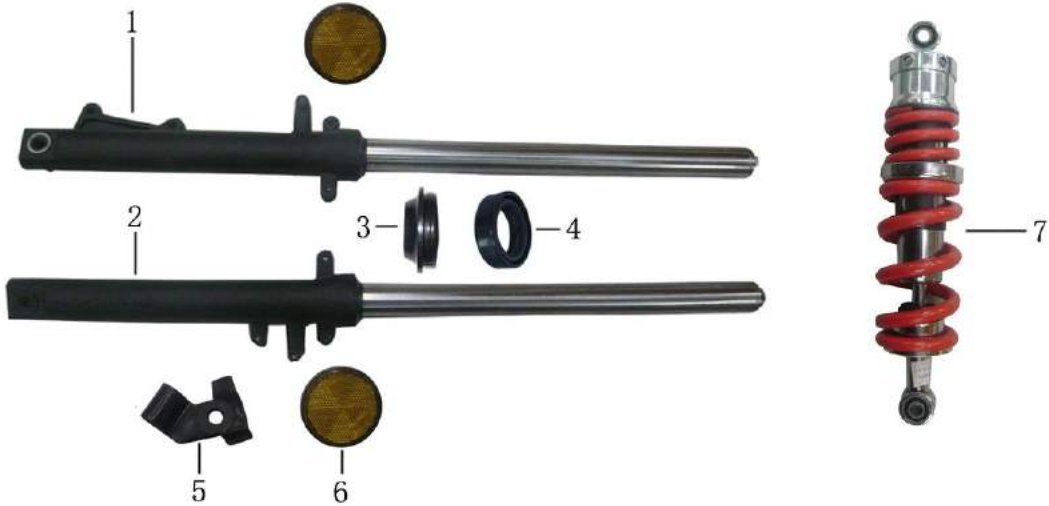

1501067-1	Shock absorber, front, RH	
1501067-2	Shock absorber, front, LH	
1501067-3	Dust Cover	
1501067-4	Oil Seal,Front Shock Absorber	
1501067-5	Stay, speed sensor	
1501067-6	Reflector, front	
1501067-7	Shock absorber Assy, rear	



1501068-1	Rubber, front fuel tank	
1501068-2R	Tank weldment, fuel Rd	
1501068-3	Sensor, fuel	
1501068-4	Cock comp., fuel	
1501068-5	Handle, fuel cock	
1501068-6	Cushion, rear fuel tank	

F-09 油箱护板 FUEL TANK GUARD



1501069-1R	Ornament set, fuel tank, RH Red	
1501069-2	Ornament, fuel tank inner, RH	
1501069-3	Ornament, fuel tank inner, LH	
1501069-4R	Ornament set, fuel tank, LH Red	



15010610-1	Tyre, front	
15010610-2	Hub comp., front wheel	
15010610-3	Disc, front brake	
15010610-4	Axle, front	
15010610-5	Bush, front wheel, RH	
15010610-6	Sensor, speed	

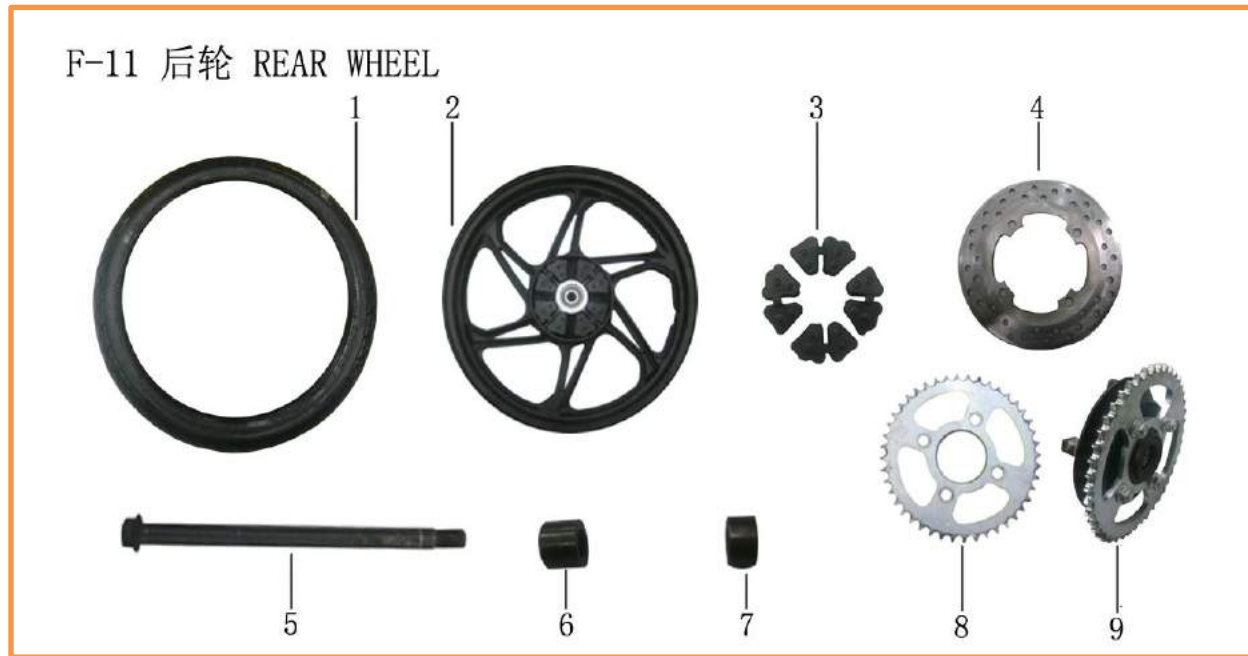

15010611-1	Tyre, rear	
15010611-2	Hub, rear wheel	
15010611-3	Buffer, rear wheel	
15010611-4	Disc, rear brake	
15010611-5	Axle, rear	
15010611-6	Rear Wheel Bush,LH	
15010611-7	Rear Wheel Bush, RH	
15010611-8	Sprocket	
15010611-9	Hub Assy, sprocket	

F-12 后叉 REAE FORK

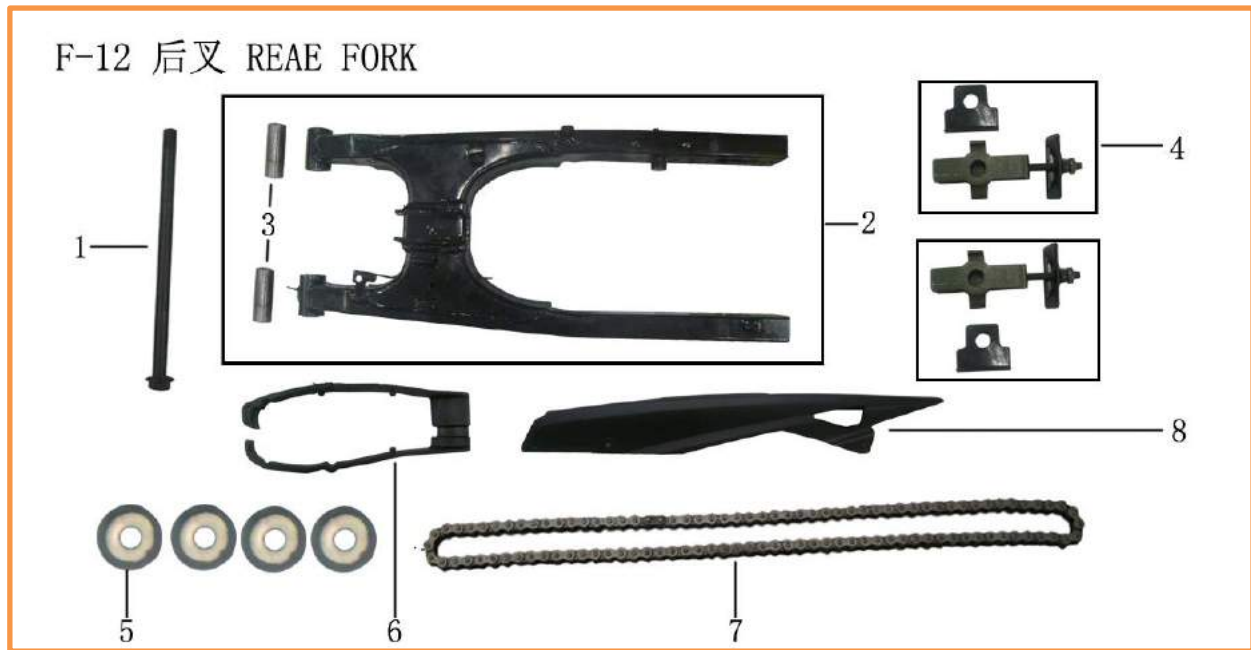

15010612-1	Shaft, rear fork	
15010612-2	Fork comp., rear	
15010612-3	Bush, rear fork, inner	
15010612-4	Adjuster set, chain	
15010612-5	Dust cover, rear fork shaft	
15010612-6	Guide, chain	
15010612-7	Chain, 08MCx126	
15010612-8	Chaincase	

F-13 坐垫 空滤器 SEAT & AIR CLEANER



15010613-1	Seat Assy	
15010613-2	Cleaner Assy, air	
15010613-3	Element, air cleaner	

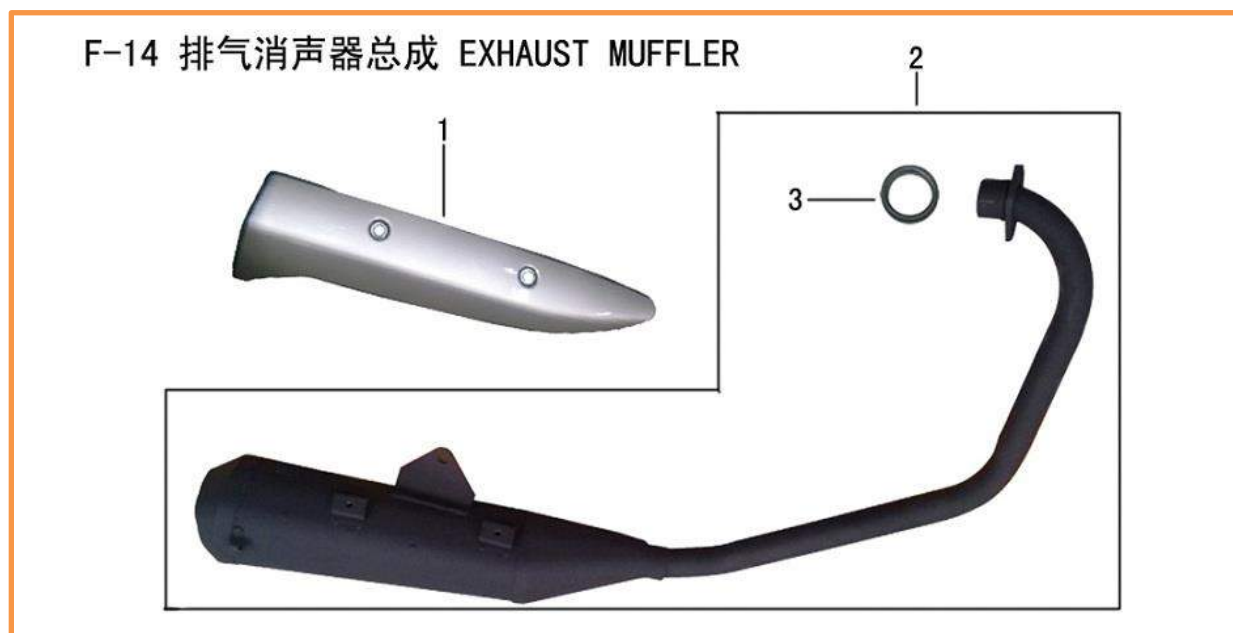

15010614-1	Ornament, muffler	
15010614-2	Muffler Assy, exhaust	
15010614-3	Gasket set, muffler	



15010615-1	Stand, center	
15010615-2	Shaft, center stand	
15010615-3	Spring, center stand	
15010615-4	Spring, side stand	
15010615-5	Bolt, pivot	
15010615-6	Stand, side	



15010616-1	Flap, rear mud	
15010616-2	Cover, tool box	
15010616-3	Fender, rear	
15010616-4	Ornament, rear	
15010616-5	Light comp., license plate	
15010616-6	Bracket set, front body	
15010616-7	Reflector, rear	
15010616-8	Kit, tool	



15010617-1	Footrest Assy, rider, RH	
15010617-2	Footrest Assy, rider, LH	
15010617-3	Lever, gearshift	
15010617-4	Pivot, gearshift pedal	
15010617-5	Footrest comp., rider, RH	
15010617-6	Treadle, pillion, RH	
15010617-7	Footrest comp., rider, LH	
15010617-8	Treadle, pillion, LH	



15010618-1	Cable, main	
15010618-2	Horn	
15010618-3	Rectifier	
15010618-4	Relay, flashing	
15010618-5	Controller, ignition	
15010618-6	Relay, starting	
15010618-7	Coil, ignition	
15010618-8	Battery,12N9-BS	



15010619-1	Bulb, RY12V10W	
15010619-2	Winker, front, LH	
15010619-3	Winker, front, RH	
15010619-4	Winker, rear, LH	
15010619-5	Winker, rear, RH	
15010619-6	Taillight Assy	

F-20 后围板 侧盖 REAR PANEL & SIDE COVER



15010620-1	Panel, rear	
15010620-2R	Ornament, rear panel, LH Red	
15010620-3R	Ornament, rear panel, RH Red	
15010620-4	Plate, rear panel connecting, LH	
15010620-5	Plate, rear panel connecting, RH	
15010620-6	Cover set, side, LH	
15010620-7	Cover set, side, RH	
15010620-8	Ornament, side cover, LH	
15010620-9	Ornament, side cover, RH	



15010621-1	Rear Hydraulic Disc Brake	
15010621-2	Bracket set, rear brake reservoir	
15010621-3	Bracket set, rear brake master cylinder	
15010621-4	Spring set, rear brake pedal	
15010621-5	Pedal, rear brake	
15010621-6	Rear Brake Shoe Set	

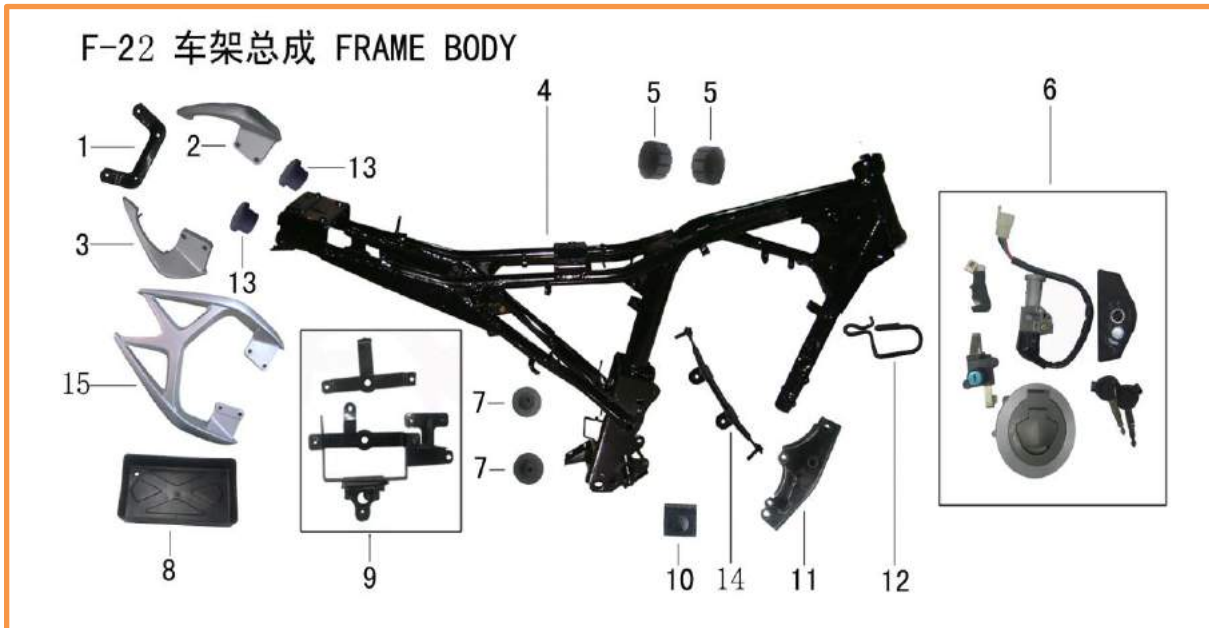

15010622-1	Bracket set, rear panel	
15010622-2	Handrail, LH	
15010622-3	Handrail, RH	
15010622-4	Body weldment, frame	
15010622-5	Cushion, fuel tank front	
15010622-6	Lock Assy	
15010622-7	Cushion, battery	
15010622-8	Case, battery	
15010622-9	Stay set, battery	
15010622-10	Rubber, center stand	
15010622-11	Plate, engine front connecting	
15010622-12	Clamp, main cable	
15010622-13	Frame Hole Plug	
15010622-14	Fuel Tank Ornament Bracket	
15010622-15	Rear Handrail	

157FMJ-3

Engine Parts

LF150-10F



UNIVERSAL
H A R D W A R E®

Box 585, Center Road
Spanish Lookout
Tel 501 823 0254
sales@universalhardware.bz

3380 Chetumal Street
Belize City
Tel 501 224 4140
salesbz@universalhardware.bz



1571-1	Check Valve Vent Pipe Comp.	
1571-2	Check Valve Vent Pipe Shim	
1571-3	Cap nut M8	
1571-4	Copper washer, bolt, cylinder	
1571-5	Head unit, cylinder	
1571-6	Spark plug	
1571-7	Inle pipe set	
1571-8	Block unit, cylinder	
1571-9	Gasket, cylinder block	
1571-10	Gasket, cylinder head	
1571-11	Cover, cylinder head, LH	
1571-12	Bolt, M8×45	
1571-13	Gasket, cover, cylinder head, LH	
1571-14	Retainer, distributing camshaft	
1571-15	Valve Cover O-Ring	
1571-16	Cover, valve	
1571-17	Dowel pin, cylinder headΦ10×20	
1571-18	Dowel pin, cylinder headΦ10×14	
1571-19	Washer, Tensioner	
1571-20	Tensioner Assy	

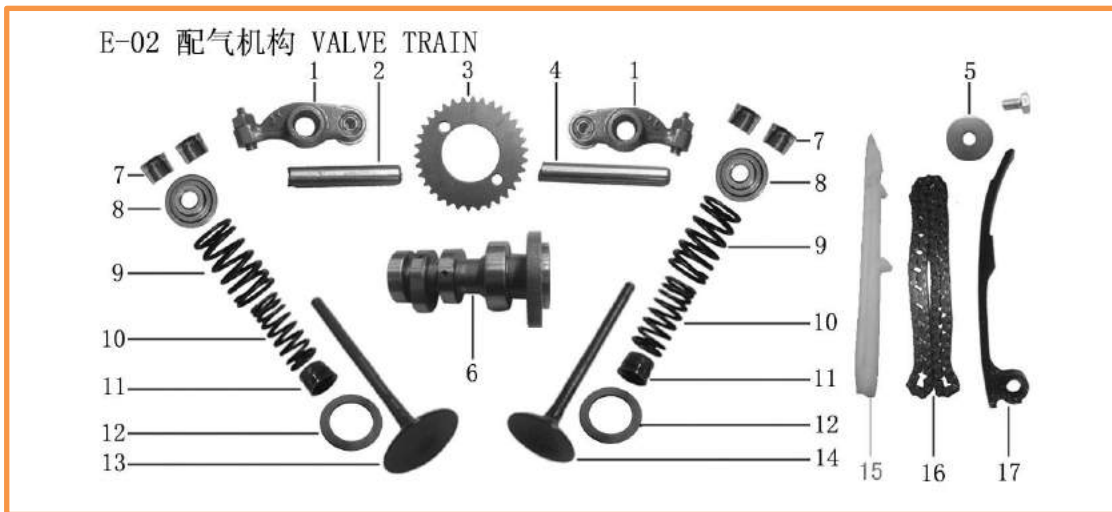

1572-1	Rocker arm Assy,	
1572-2	Shaft, rocker arm II	
1572-3	Sprocket, timing driven	
1572-4	Shaft, rocker arm I	
1572-5	Washer, tensioning plate	
1572-6	Camshaft Assy I	
1572-7	Split cone, valve	
1572-8	Seat, spring, upper	
1572-9	Spring, valve, outer	
1572-10	Spring, valve, inner	
1572-11	Oil seal, valve stem	
1572-12	Valve Outer Spring Seat	
1572-13	Valve, intake	
1572-14	Valve, exhaust	
1572-15	Guiding plate	
1572-16	Chain, timing	
1572-17	Tensioner	

E-03 右曲轴箱盖 RIGHT CRANKCASE COVER



1573-1	Clutch Controlling Rod	
1573-2	Clutch Lever Oil Seal	
1573-3	Clutch Lever Spring	
1573-4	Spring, operating shaft, clutch	
1573-5	Dipstick comp.	
1573-6	O-ring, dipstick	
1573-7	Oil seal, starting shaft	
1573-8	Cover comp., crankcase, RH	
1573-9	Stay, clutch cable adjusting	
1573-10	Gasket, crankcase cover, RH	
1573-11	Glass, sight	
1573-12	Head, cylinder Set Pin	

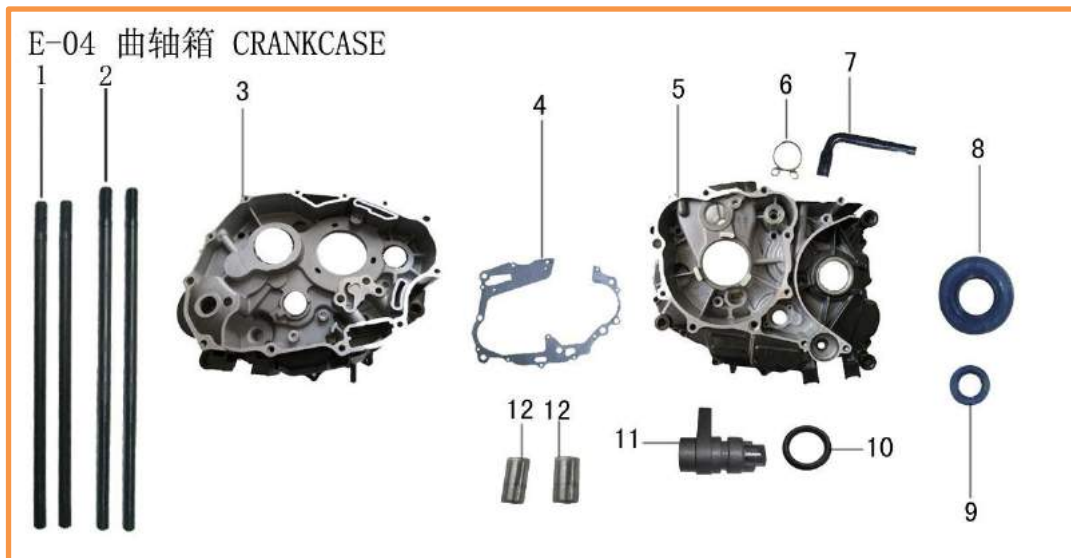

1574-1	Stud AM8×207		
1574-2	Stud BM8×212		
1574-3	Crankcase, RH		
1574-4	Gasket, crankcase		
1574-5	Crankcase, LH		
1574-6	Clip, exhaust pipe		
1574-7	Pipe, exhaust		
1574-8	Oil seal,		
1574-9	Oil seal, gearshift shaft		
1574-10	pin-keeping O-Ring		
1574-11	Body comp., pin-keeping		
1574-12	Dowel pin (Φ10×14)		



1575-1	Oil Pump Assy	
1575-2	Starting motor	
1575-3	Shaft, dual-gear I	
1575-4	Washer, Dual-gear	
1575-5	Dual-gear comp. I	
1575-6	Gear set, starting clutch	
1575-7	Dual-gear comp.II	
1575-8	Shaft, dual-gear II	
1575-9	Washer, Dual-gear II	
1575-10	Oil Pump Gasket	



1576-1	Stator set, magneto		
1576-2	Flywheel clutch Assy		
1576-3	Starting clutch Assy		
1576-4	Bolt,		
1576-5	Thrust washer		
1576-6	Plug, watch hole		
1576-7	O-ring, watch hole plug		
1576-8	Cover, crankcase, LH		
1576-9	O-ring, $\Phi 63 \times \Phi 3$		
1576-10	Cover, upper		
1576-11	Gasket, crankcase cover, LH		
1576-12	Dowel pin, crankcase		
1576-13	Cover, LH		
1576-14	O-ring, plug,		
1576-15	Rear cover, LH		

E-07 离合器 CLUTCH



1577-1	Body, clutch	
1577-2	Clutch Pusher	
1577-3	Bearing, 16003	
1577-4	Lock nut	
1577-5	Thrust washer	
1577-6	Plate, clutch lifter	
1577-7	Spring, Clutch	
1577-8	Disc set, clutch friction	
1577-9	Plate, clutch	
1577-10	Plate, clutch pressure	
1577-11	Center comp., clutch	
1577-12	Clutch Assy	
1577-13	Outer comp., clutch	
1577-14	Spline washer	

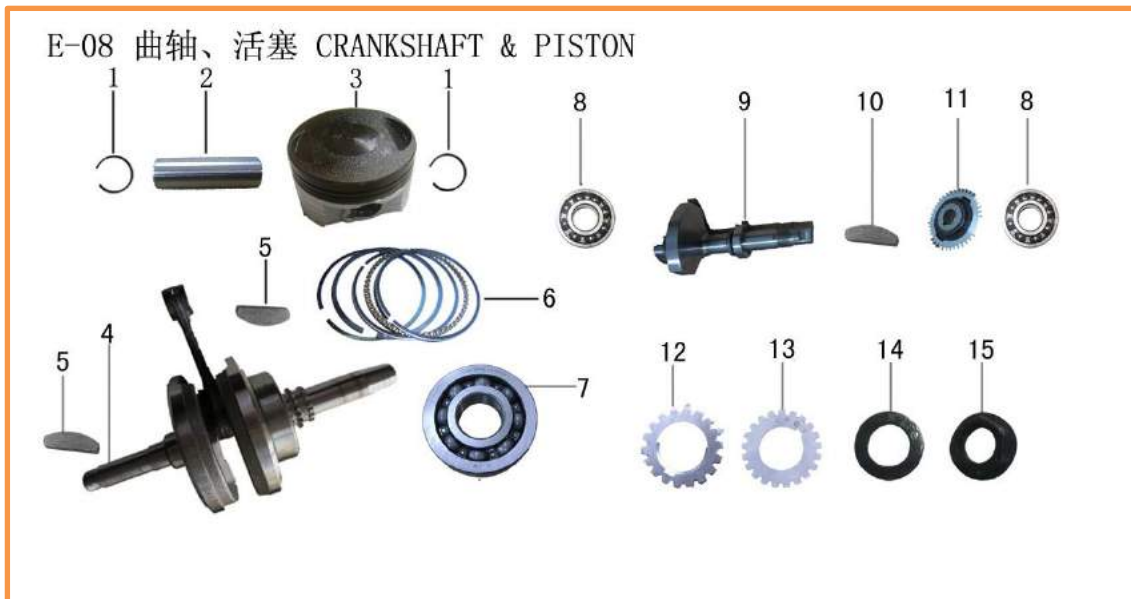

1578-1	Circlip, piston pin	
1578-2	Pin, piston	
1578-3	Piston	
1578-4	Rod comp., crankshaft connecting	
1578-5	Key, woodruff	
1578-6	Ring set, piston	
1578-7	Bearing, crankshaft, RH	
1578-8	Bearing,	
1578-9	Shaft, balanced	
1578-10	Key, woodruff	
1578-11	Gear, balanced shaft driven Assy	
1578-12	Gear, balanced shaft drive	
1578-13	Gear, primary drive	
1578-14	Thrust washer	
1578-15	Lock nut	

E-09 传动装置 TRANSMISSION

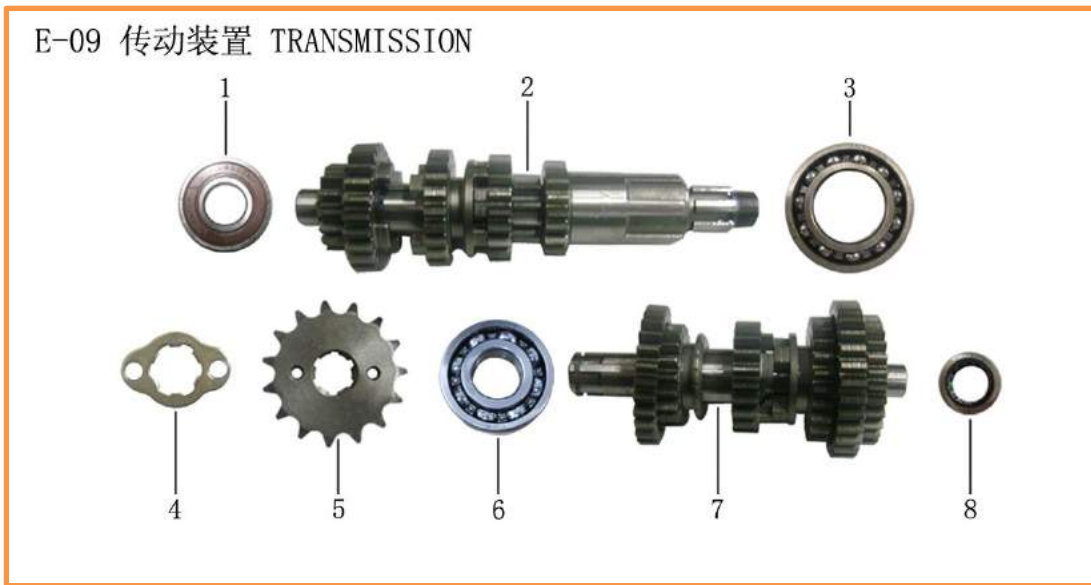

1579-1	Bearing, 6202 RS	
1579-2	Main shaft Assy	
1579-3	Bearing, 6006	
1579-4	Locating plate, sprocket	
1579-5	Sprocket, output	
1579-6	Bearing, 6204	
1579-7	Countershaft Assy	
1579-8	Bearing, needle, HK152312	

E-10 变档机构 GEARSHIFT DEVICE

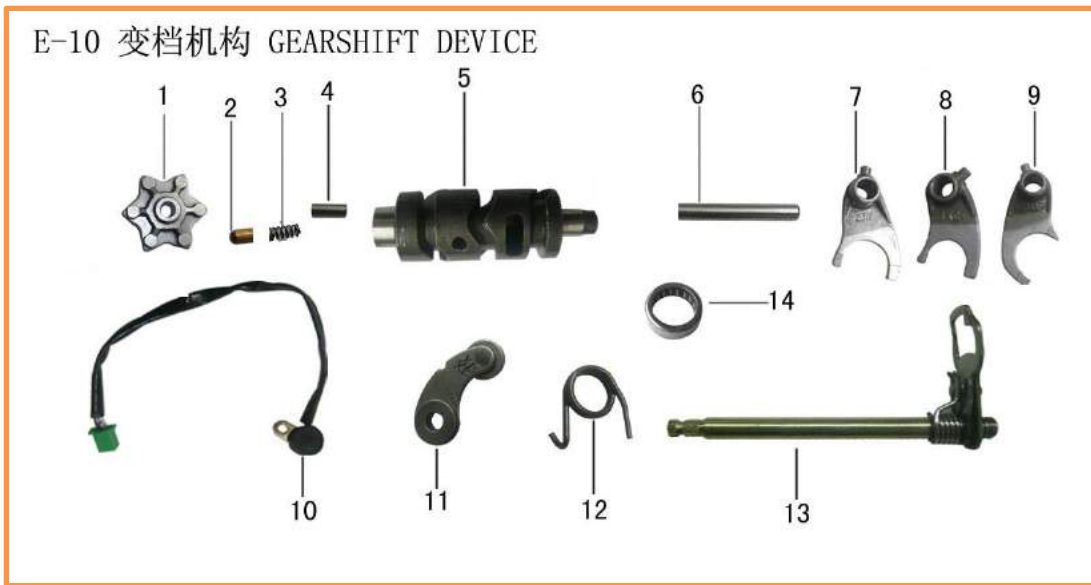

15710-1	Cam	
15710-2	Pin, gear indicating	
15710-3	Spring, Pin	
15710-4	Set pin,	
15710-5	Drum	
15710-6	Shaft, fork	
15710-7	Fork (III)	
15710-8	Fork (II)	
15710-9	Fork (I)	
15710-10	Indicator, gear	
15710-11	Limit plate	
15710-12	Spring	
15710-13	Gearshift shaft Assy	
15710-14	Bearing, needle	

E-11 化油器、变档杆 GEARSHIFT PEDAL & CARBURETOR

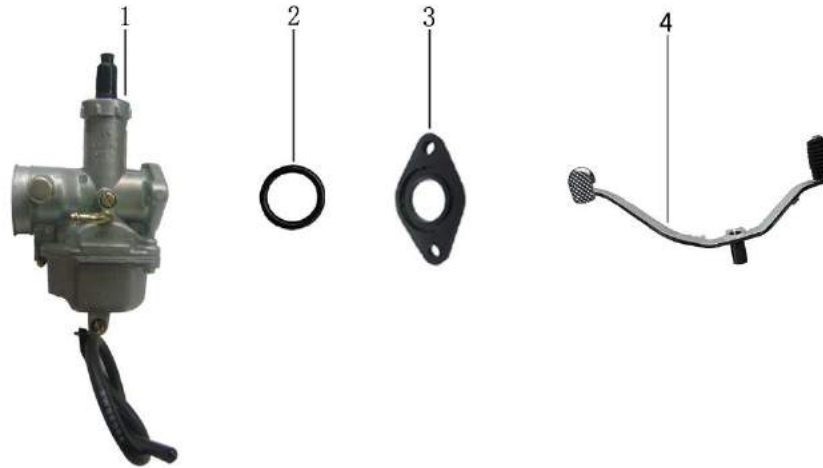

15711-1	Carburetor Assy	
15711-2	Inlet Pipe Insulator O-Ring	
15711-3	Inlet Pipe Insulator	
15711-4	Gearshift pedal Assy	

E-12 电器 ELECTRIC ELEMENTS



15712-1	Ignition Controller	
15712-2	Start Relay	
15712-3	Voltage Regulator	
15712-4	Ignition Coil	

LF 150-10F

Parts Catalog

- **Always wear a helmet while driving
Motorcycles**
- **Always have your headlights on while driving,
even during the day – for safety reasons and
longer battery life**
- **Make sure all lights work properly at all times**
- **Always drive with Insurance Coverage,
Licensed Motorcycle and Motorcycle Driver's
License**
- **Change oil (SAE15W/40SE) after the first 500
KMs and after every 2,000 KMs**
- **Use Regular Gas**
- **Always Drive with Awareness for
SAFETY.**





Meilun Motorcycle Warranty Policy

Meilun Motorcycles are under 3 months or 2,000 KMs warranty – whichever comes first. Specific items under warranty are:

- The Engine, and its related parts
- Cables, Horn, Switches
- And any other manufacturer's defect on motorcycle.

The following items are *not* covered under this warranty:

- Tires, Tubes, Chain & Sprockets
- Covers, Mirrors, Light Lenses, Alarm System
- Battery – unless convincing evidence shows defect
- And any other damages or wear & tear occurring under the owner's care.